

Make a Flower Headdress

You will need:

- ❖ The Flower headdress templates.
- ❖ A4 blue, pink & yellow craft card.
- ❖ Pencil.
- ❖ Scissors.
- ❖ Hole punch.
- ❖ String: 2×50cms in length.
- ❖ Scoring tool with ball tip.
- ❖ Ruler.
- ❖ Adhesive glue.

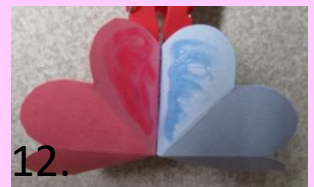
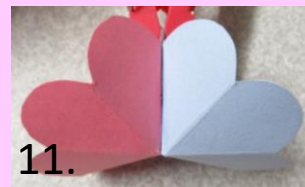
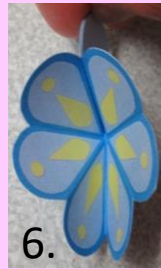
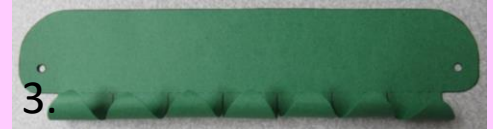
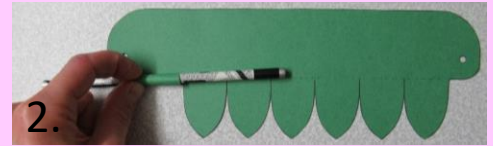
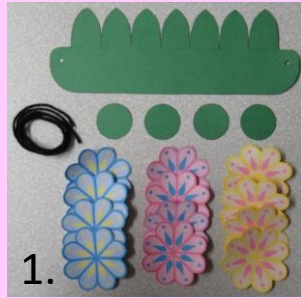

How to make the headdress:

1. **The headdress base and circles (template 1):** Cut along the solid outline of the headdress and the four circles. Draw the outline of the shapes onto green craft card and cut out the shapes (see photograph 1).
2. Pierce the holes on each side of the headdress, using a pencil or a hole punch.
3. Using a pencil, wrap and roll the leaves towards the dashed lines, creating leaves which curl (see photographs 2 and 3).
4. **The flowers (templates 2):** Cut around the flowers and stick them onto matching colour craft card. When dry, cut around the outline of the flowers again (see photograph 1).
5. Use a ball tip scorer and ruler to mark over the middle of the thick criss-cross lines on the flowers (see photograph 4). Fold along each scored line to define the shape of each petal.
6. Add a small amount of glue onto one petal. Fold in and fix to the petal next to it (see photographs 5 and 6).
7. Add glue onto the back of the paired petals and stick them onto the back of the petal next to them (see photographs 7 and 8).
8. **Group the flowers together:** There needs to be four sets of three flowers, one of each colour in each group (see photograph 9).
9. In each set, select one flower. Glue one petal on the outside. Align and fix onto a second flower (see photographs 10 and 11). Add glue to the paired flowers again (see photograph 12). Align and attach the third flower (see photograph 13). Glue under each flower in the set and secure the flowers by fixing the green circle (see photographs 14 and 15).
10. Add adhesive onto the green base of the flowers (see photograph 16) and bond the decorative flowers upon the base of the headdress. String the headdress to complete the craft (see photograph 17).

Caution: Adult supervision will be required when using scissors, hole punch, pencil, string, scorer and glue. Small parts can be a choking hazard. Do not leave children unattended during project.

Headdress base and circles (template 1)

Cut along the outline of the shapes ✂

Draw the outline of the shapes onto green craft card and cut the shapes out.

Using a pencil, wrap and roll the leaves towards the dashed lines, creating leaves which curl. →

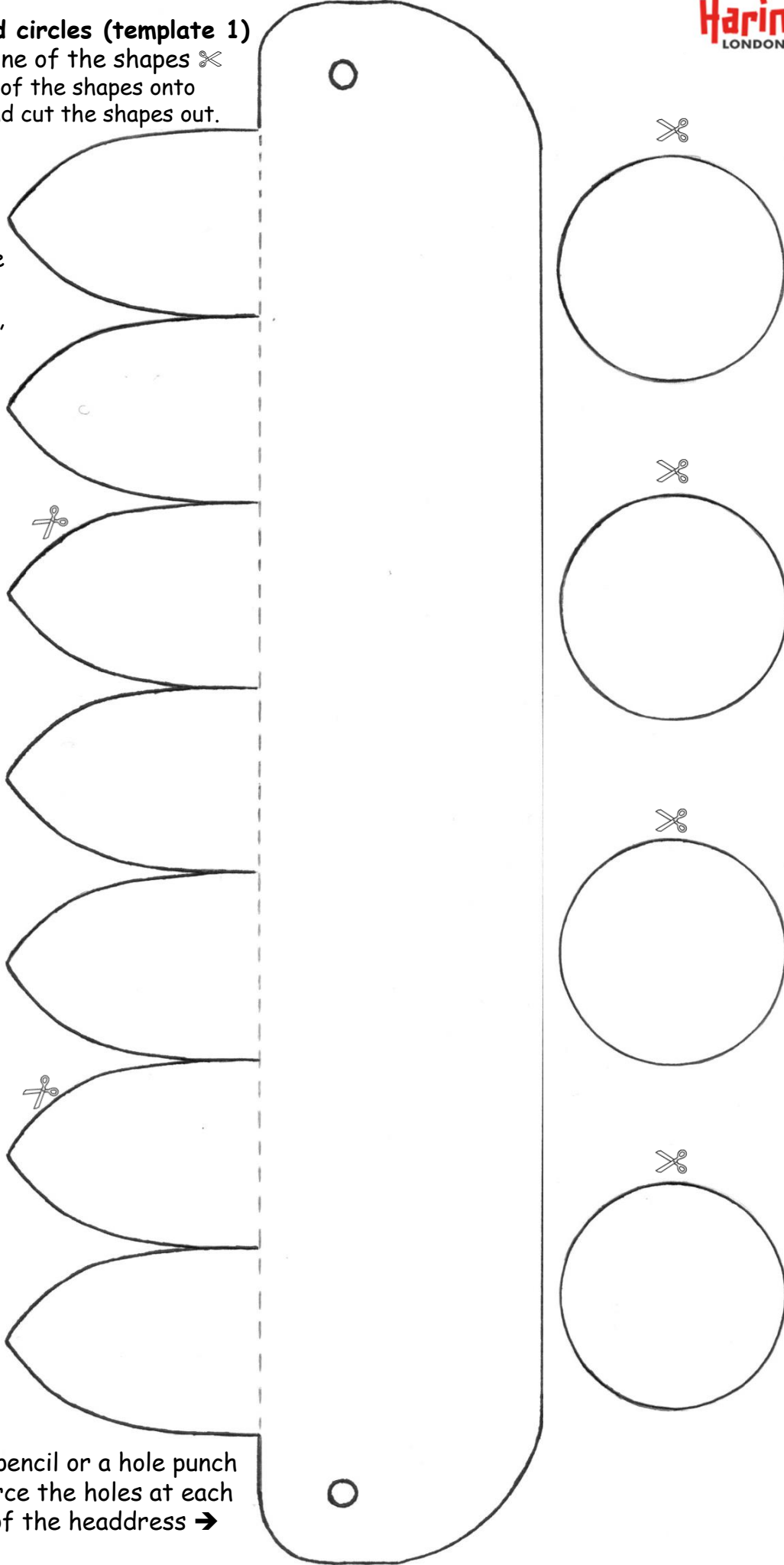

Use a pencil or a hole punch to pierce the holes at each end of the headdress →

Flowers (template 2)

Cut along the outline of the flowers ✂
Stick them onto matching colour craft card.
When dry, cut them out again.

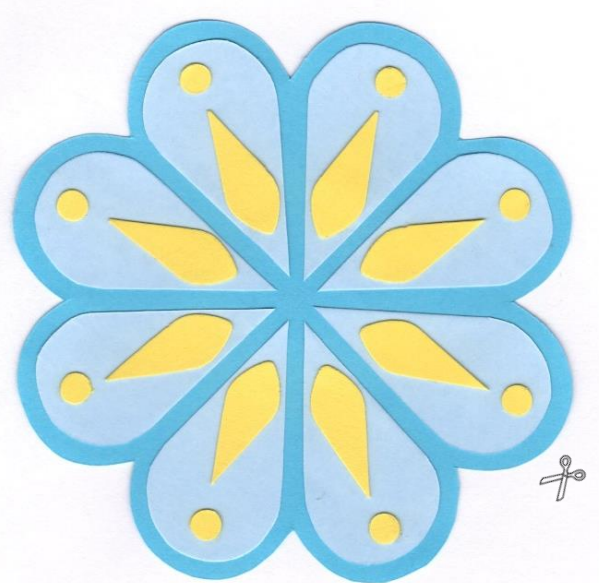
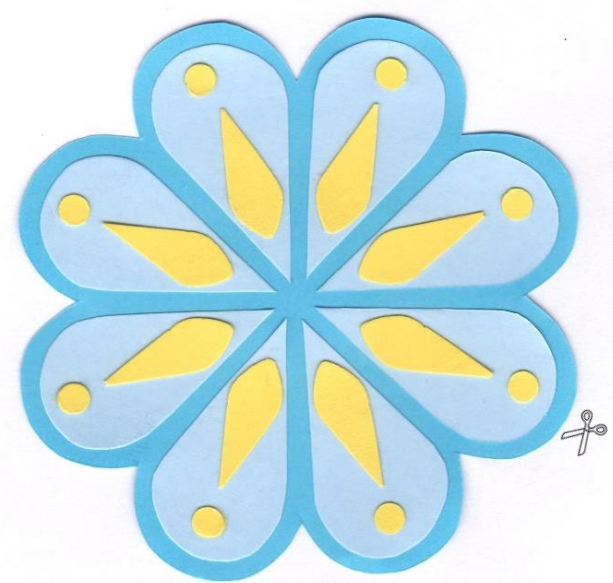

Caution: Adult supervision will be required when using scissors, hole punch, pencil, string, scorer and glue. Small parts can be a choking hazard. Do not leave children unattended during project.

Flowers (template 2)

Cut along the outline of the flowers ✂
Stick them onto matching colour craft card.
When dry, cut them out again.

