

THE HARINGEY (TURNPIKE LANE IMPROVEMENT PROJECT) (TEMPORARY PROHIBITION AND RESTRICTION OF TRAFFIC) ORDER 2024

The Council of the London Borough of Haringey has made the above Temporary Traffic Order under S14(1) Road Traffic Regulation Order 1984 described below:-

Turnpike Lane N8, Waldegrave Road N8, Vernon Road N8, Burghley Road N8 & Lyttleton Road N8	
Reason for 14(1) Order – To accommodate improvement works to Turnpike Lane and adjacent junctions	
Scheduled dates	General Effect of the Order
<p>Date: 3rd March 2025 to 13th June 2025</p> <p>Times: 24hrs</p>	<p>1. Suspension of Resident Permit Holder Only bays and pay by phone parking bays on both sides of Lyttleton Road N8:</p> <p>a. Adjacent to the flank wall of No.23 Waldegrave Road</p> <p>b. Adjacent to the flank wall of No.25 Waldegrave Road</p> <p>No parking/waiting/loading/unloading</p>
<p>Date: 10th March 2025 to 13th June 2025</p> <p>Times: 24hrs</p> <p>NOTE: The works for stages 1 to 3 would not occur simultaneously in all roads, with completion of each stage anticipated to be within 4-6 weeks.</p>	<p>Stage 1</p> <p>2. Road closure of Waldegrave Road N8, from the junction with Turnpike Lane northwest for approximately 30 metres (access to No.1a/rear of No.18 Turnpike Lane will be maintained).</p> <p>Diversion route will be available via Turnpike Lane, Vernon Road, Lyttleton Road and Vice Versa.</p> <p>3. Suspension of parking and introduction of no waiting/no loading at any time outside No.9 Turnpike Lane N8.</p>
	<p>Stage 2</p> <p>4. Road closure of Burghley Road N8, from the junction with Turnpike Lane northwest for approximately 25 metres (access to rear of No.58/60 Turnpike Lane will be maintained).</p> <p>Diversion route will be available via Turnpike Lane, Vernon Road, Lyttleton Road and Vice Versa.</p> <p>5. To suspend resident permit holders only parking outside No.2&4 Burghley Road except for blue badge holders to accommodate suspension of two disabled bays adjacent to No.58 Turnpike Lane during road closure.</p> <p>6. Suspension of parking and introduction of no waiting/no loading at any time outside No.43 to No.63 Turnpike Lane N8.</p>
	<p>Stage 3</p> <p>7. Road closure of Vernon Road N8, from the junction with Turnpike Lane northwest for approximately 25 metres (access to rear of No.38 Turnpike Lane will be maintained).</p> <p>Diversion route will be available via Turnpike Lane, Burghley Road, Lyttleton Road and Vice Versa.</p> <p>8. Suspension of parking and introduction of no waiting/no loading at any time outside No.15a to No.39 Turnpike Lane N8.</p>

The order will come into operation on 3rd March 2025 and may continue in force for up to 18 months or until works have been completed, whichever is earlier.

The provisions of the Orders shall apply only at such times and as directed by traffic signs. For road closures, alternative routes will be directed by traffic signs. Access will be maintained where possible. For more information contact visit our website at www.haringey.gov.uk/traffic_orders

Date: 26th February 2025

Ann Cunningham,
Traffic Management,

LONDON BOROUGH OF HARINGEY

THE HARINGEY (TURNPIKE LANE IMPROVEMENT PROJECT) (TEMPORARY PROHIBITION AND RESTRICTION OF TRAFFIC) ORDER 2025

Made: 26th February 2025

Coming into force: 3rd March 2025

The 'Council' of the London Borough of Haringey being the traffic authority for certain roads in that London borough is satisfied that traffic should be prohibited because works are being or are proposed to be executed on or near those roads and in exercise of its powers under Section 14(1) of the Road Traffic Regulation Act 1984, as amended and of all other enabling powers the Council hereby makes the following Order.

1. This Order shall come into force on 3rd March 2025 and may be cited as the Haringey (Turnpike Lane Improvement Project (Temporary Prohibition and Restriction of Traffic) Order 2025.
2. Whilst the Order is in force, no person shall cause or permit any vehicle to: -
 - (a) wait, load or unload in the lengths of roads specified in column 2 of Schedule 1 to this Order during the dates and times specified in column 1 of that Schedule;
 - (b) enter or proceed in the lengths of road specified in column 2 of Schedule 2 to this order during the dates and times specified in column 1 of that Schedule.
3. Whilst this Order is in force, any parking place or waiting restrictions located in a length of road specified in column 2 of Schedule 1 to this Order shall be suspended during the dates and times specified in column 1 of that Schedule.
4. 'The Haringey (Free Parking Places, Loading Places and Waiting, Loading and Stopping Restrictions) Order 2021' and 'The Haringey (Charged-For Parking Places) Order 2021' are hereby temporarily amended as detailed in Article 2 and 3 to this Order.
5. The prohibitions and restrictions specified in articles 2 and 3 above shall apply only during such times and to such extent as shall be indicated by traffic signs as prescribed by The Traffic Signs Regulations and General Directions 2016.
6. Nothing in Article 2 to this Order shall apply to: -
 - (a) any vehicle being used in connection with the works;
 - (b) any vehicle being used for fire brigade, police or ambulance purposes;
 - (c) anything done with the permission or at the direction of a police constable in uniform, a traffic warden or a civil enforcement officer;
 - (d) any vehicle requiring ingress to, and egress from, a property in a prohibited length of road, if the works allow.
7. The Order may continue in force for up to 18 months or until works are complete, whichever is earlier.

Dated: 26th February 2025

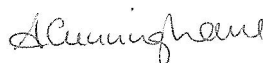

Ann Cunningham
Head of Highways & Parking

Schedule 1 – Suspensions & Introduction of No Waiting/No Loading at Any Time

1	2
Scheduled dates	Lengths of Roads
<p>Date: 3rd March 2025 to 13th June 2025</p> <p>Times: 24hrs</p>	<p>Suspension of Resident Permit Holder Only bays and pay by phone parking bays on both sides of Lyttleton Road N8:</p> <ol style="list-style-type: none"> Adjacent to the flank wall of No.23 Waldegrave Road Adjacent to the flank wall of No.25 Waldegrave Road <p>No parking/waiting/loading/unloading</p>
<p>Date: 10th March 2025 to 13th June 2025</p> <p>Times 24hrs</p> <p>NOTE: The works for stages 1 to 3 would not occur simultaneously in all roads, with completion of each stage anticipated to be within 4-6 weeks.</p>	<p>Stage 1:</p> <ol style="list-style-type: none"> Suspension of parking and introduction of no waiting/no loading at any time outside No.9 Turnpike Lane N8. <p>Stage 2:</p> <ol style="list-style-type: none"> To suspend resident permit holders only parking outside No.2&4 Burghley Road except for blue badge holders to accommodate suspension of two disabled bays adjacent to No.58 Turnpike Lane during road closure. <p>Stage 3:</p> <ol style="list-style-type: none"> Suspension of parking and introduction of no waiting/no loading at any time outside No.43 to No.63 Turnpike Lane N8. <p>Stage 3:</p> <ol style="list-style-type: none"> Suspension of parking and introduction of no waiting/no loading at any time outside No.15a to No.39 Turnpike Lane N8. <p>No parking/waiting/loading/unloading</p>

Schedule 2 – Road Closure

1	2
Scheduled dates	Lengths of Roads
<p>Date: 10th March 2025 to 13th June 2025</p> <p>Times 24hrs</p> <p>NOTE: The works for stages 1 to 3 would not occur simultaneously in all roads, with completion of each stage anticipated to be within 4-6 weeks.</p>	<p>Stage 1:</p> <ol style="list-style-type: none"> Road closure of Waldegrave Road N8, from the junction with Turnpike Lane northwest for approximately 30 metres (access to No.1a/rear of No.18 Turnpike Lane will be maintained). <p>Diversion route will be available via Turnpike Lane, Vernon Road, Lyttleton Road and Vice Versa.</p> <p>Stage 2:</p> <ol style="list-style-type: none"> Road closure of Burghley Road N8, from the junction with Turnpike Lane northwest for approximately 25 metres (access to rear of No.58/60 Turnpike Lane will be maintained). <p>Diversion route will be available via Turnpike Lane, Vernon Road, Lyttleton Road and Vice Versa.</p> <p>Stage 3:</p> <ol style="list-style-type: none"> Road closure of Vernon Road N8, from the junction with Turnpike Lane northwest for approximately 25 metres (access to rear of No.38 Turnpike Lane will be maintained). <p>Diversion route will be available via Turnpike Lane, Burghley Road, Lyttleton Road and Vice Versa.</p>

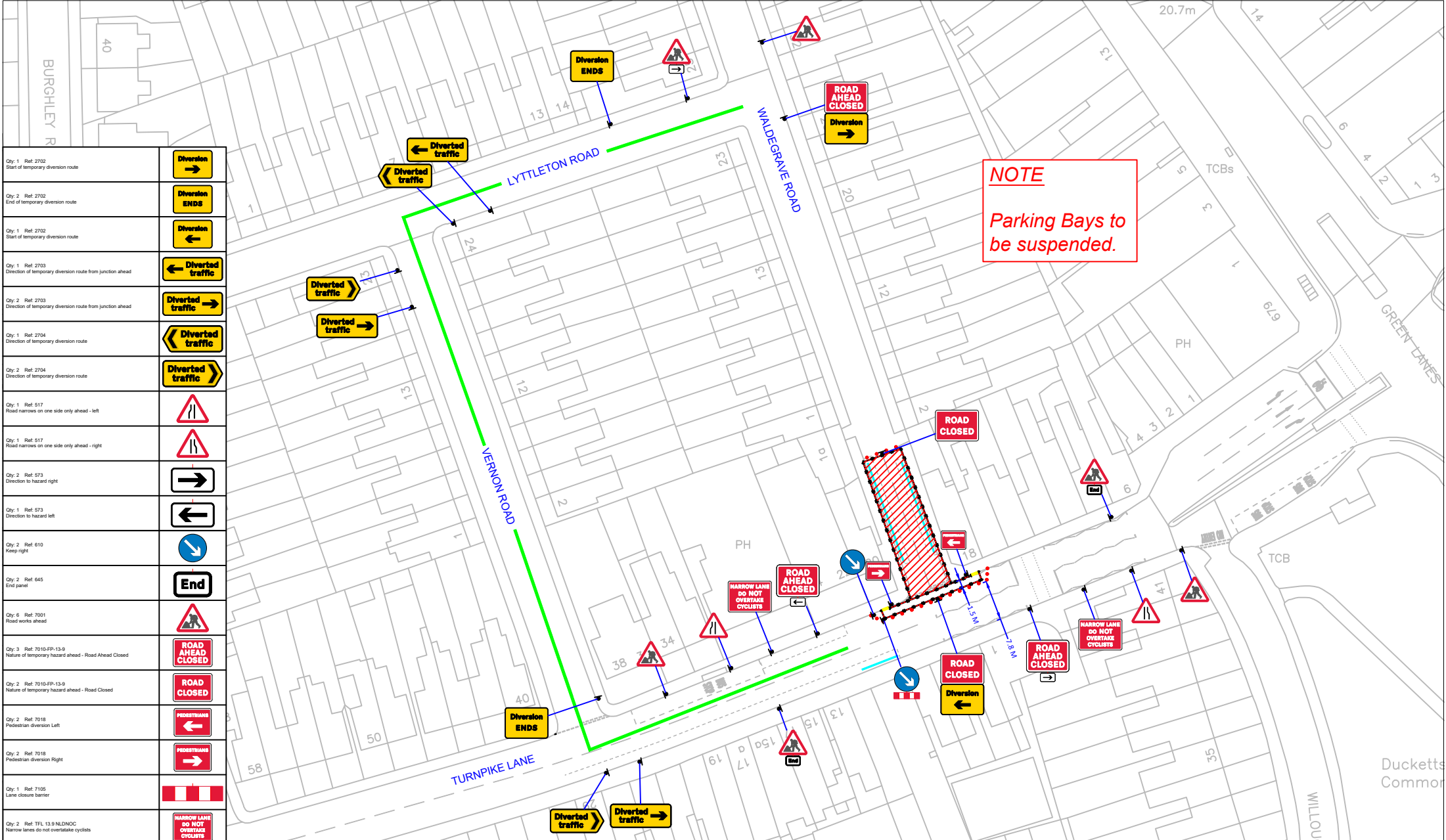

City: 1 Ref: 2702 Start of temporary diversion route	
City: 2 Ref: 2702 End of temporary diversion route	
City: 1 Ref: 2702 Start of temporary diversion route	
City: 1 Ref: 2703 Direction of temporary diversion route from junction ahead	
City: 2 Ref: 2703 Direction of temporary diversion route from junction ahead	
City: 1 Ref: 2704 Direction of temporary diversion route	
City: 2 Ref: 2704 Direction of temporary diversion route	
City: 1 Ref: 517 Road narrows on one side only ahead - left	
City: 1 Ref: 517 Road narrows on one side only ahead - right	
City: 2 Ref: 573 Direction to hazard right	
City: 1 Ref: 573 Direction to hazard left	
City: 3 Ref: 610 Keep right	
City: 2 Ref: 645 End panel	
City: 6 Ref: 7001 Road works ahead	
City: 3 Ref: 7010-FP-13-9 Nature of temporary hazard ahead - Road Ahead Closed	
City: 2 Ref: 7010-FP-13-9 Nature of temporary hazard ahead - Road Closed	
City: 3 Ref: 7018 Pedestrian diversion Left	
City: 2 Ref: 7018 Pedestrian diversion Right	
City: 1 Ref: 7105 Lane closure barrier	
City: 3 Ref: TFL 13-9 NLDNOC Narrow lanes do not overtake cyclists	

NOTE
Parking Bays to be suspended.

Ordnance Survey © Crown Copyright 2012. All rights reserved. Licence Number 100020449
Speed Limit Safety Zones
SAFETY ZONE SAFETY ZONE (LONGITUDINAL) (SEAWAYS)
0.5M 0.5M

	CONE
	WORKS AREA
	SAFETY ZONE
	TAPER
	SIGNS
	TRAFFIC SIGNAL
	PED SIGNAL
	CLOSURE
	ACCESS ONLY
	DIVERSION
	PARKING SUSPENSION
	PED RAMP
	PED BARRIER

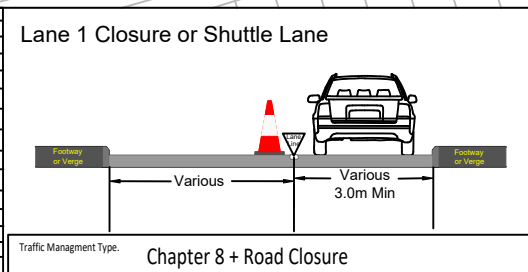

Client: **Haringey LONDON**

Site Address: **Waldegrave Road London N8 OPT**

Work Details:

Originator: **marlborough**
we understand, we deliver

Woolf House, 7 Eagle Way
Regiment Business Park
Essex Regiment Way
Chelmsford
CM3 3FY

Notes:

- All dimensions are in metres unless otherwise stated.
- All traffic management to comply with Chapter 8 and any updates, and Safety at Street Works and Road Work's (A Code of Practice)
- All road markings and signs to be as per the Traffic Signs Regulations and General Directions 2002.
- All permanent traffic signals will be bagged and switched out, at all times that temporary traffic signals are being used. This should be done with approval from said authority.
- A minimum clearance of 1.5m (absolute minimum 1.0m) to be maintained for pedestrians on footways. If this cannot be maintained signs to be placed in the dwyway with associated coming.
- Additional Road Works ahead to be used where appropriate.

Date	25 September 2024	Designer	DS
Scales @ Original Size A3	Checked	Approved	
NOT TO SCALE	NZ	WC	
Drawing Number	MH14436/001	Revision	

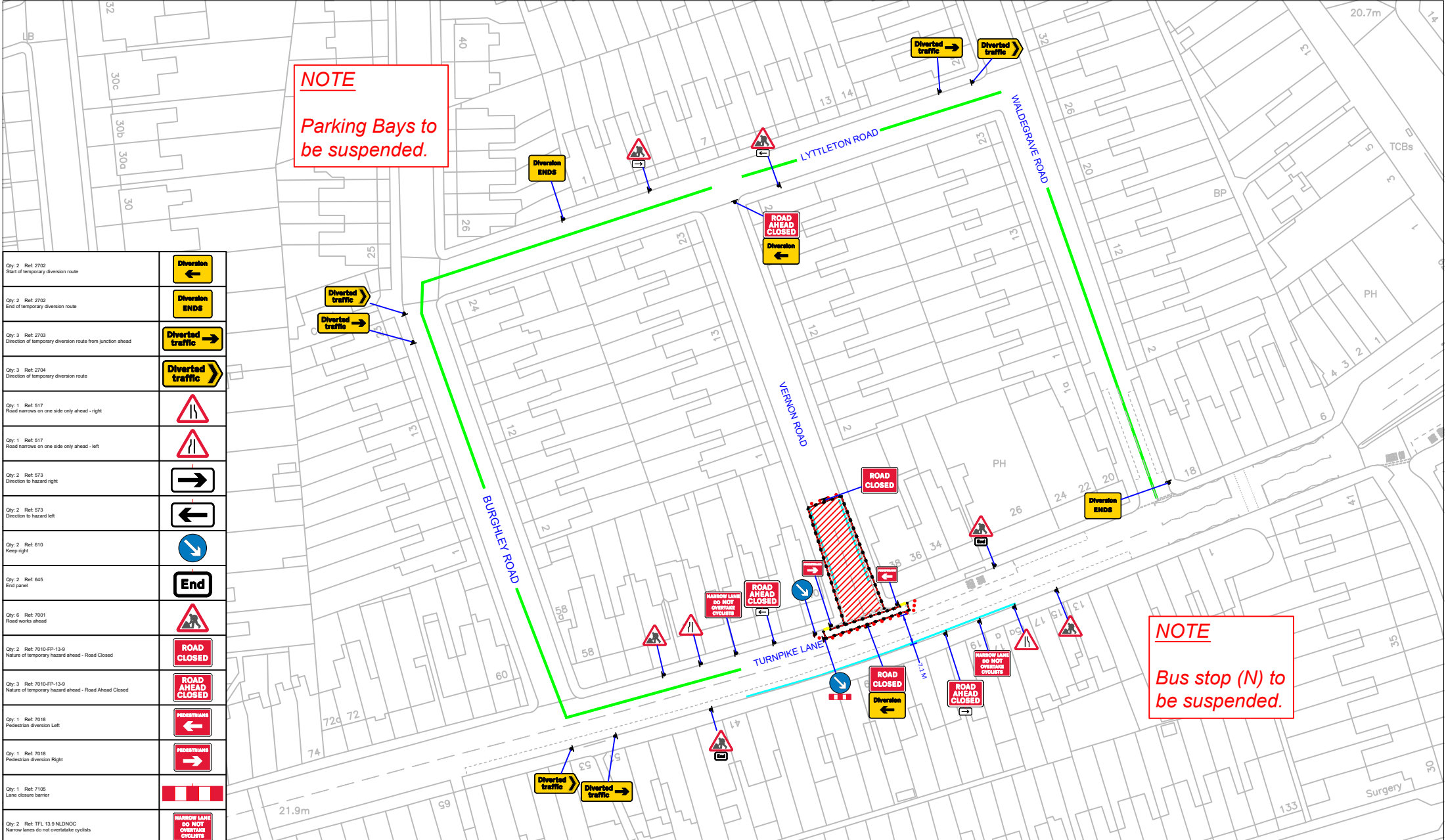

Qty: 2 Ref: 2702 Start of temporary diversion route	
Qty: 2 Ref: 2702 End of temporary diversion route	
Qty: 3 Ref: 2703 Direction of temporary diversion route from junction ahead	
Qty: 3 Ref: 2704 Direction of temporary diversion route	
Qty: 1 Ref: 517 Road narrows on one side only ahead - right	
Qty: 1 Ref: 517 Road narrows on one side only ahead - left	
Qty: 2 Ref: 573 Direction to hazard right	
Qty: 2 Ref: 573 Direction to hazard left	
Qty: 3 Ref: 610 Keep right	
Qty: 2 Ref: 645 End panel	
Qty: 6 Ref: 7001 Road works ahead	
Qty: 2 Ref: 7010-FP-13-9 Nature of temporary hazard ahead - Road Closed	
Qty: 3 Ref: 7010-FP-13-9 Nature of temporary hazard ahead - Road Ahead Closed	
Qty: 1 Ref: 7018 Pedestrian diversion Left	
Qty: 1 Ref: 7018 Pedestrian diversion Right	
Qty: 1 Ref: 7105 Lane closure barrier	
Qty: 2 Ref: TFL 13.9 NLDNOC Narrow lanes do not overtake cyclists	

Ordnance Survey ©
Crown Copyright
2012. All rights reserved.
Licence Number 100020449

Speed Limit / Safety Zones

SAFETY ZONE SAFETY ZONE
(LOW/TEMPORAL) (SIDEWAYS)
0.5M 0.5M

Key

- Red Cone: CONE
- Red Area: WORKS AREA
- Blue Area: SAFETY ZONE
- Green Line: TAPER
- Signs: SIGNS
- Traffic Signal: TRAFFIC SIGNAL
- Ped Signal: PED SIGNAL
- Red Line: CLOSURE
- Pink Area: ACCESS ONLY
- Green Area: DIVERSION
- Blue Area: PARKING SUSPENSION
- Yellow Area: PED RAMP
- Black Line: PED BARRIER

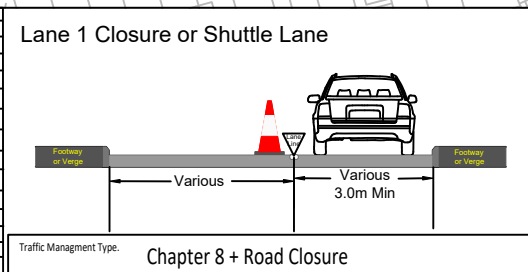

Client: **Haringey LONDON**

Site Address: **Vernon Road London N8 0QD**

Work Details:

Originator: **marlborough**
we understand, we deliver

Woolf House, 7 Eagle Way
Regiment Business Park
Essex Regiment Way
Chelmsford
CM3 3FY

Notes:

- All dimensions are in metres unless otherwise stated.
- All traffic management to comply with Chapter 8 and any updates, and Safety at Street Works and Road Work's (A Code of Practice)
- All road markings and signs to be as per the Traffic Signs Regulations and General Directions 2002.
- All permanent traffic signals will be bagged and switched out, at all times that temporary traffic signals are being used. This should be done with approval from said authority.
- A minimum clearance of 1.5m (absolute minimum 1.0m) to be maintained for pedestrians on footways. If this cannot be maintained signs to be placed in the roadway with associated coming.
- Additional Road Works ahead to be used where appropriate.

Date	25 September 2024	Designer	DS
Scale(s) @ Original Size A3	NOT TO SCALE	Checked	Approved
Drawing Number	MH14436/002	Revision	WC
			P1

NOTE
Parking Bays to be suspended.

City: 1 Ref: 2702 Start of temporary diversion route	
City: 1 Ref: 2702 Start of temporary diversion route	
City: 2 Ref: 2702 End of temporary diversion route	
City: 1 Ref: 2703 Direction of temporary diversion route from junction ahead	
City: 2 Ref: 2703 Direction of temporary diversion route from junction ahead	
City: 1 Ref: 2704 Direction of temporary diversion route	
City: 2 Ref: 2704 Direction of temporary diversion route	
City: 1 Ref: 517 Road narrows on one side only ahead - right	
City: 1 Ref: 517 Road narrows on one side only ahead - left	
City: 1 Ref: 573 Direction to hazard right	
City: 2 Ref: 573 Direction to hazard left	
City: 3 Ref: 610 Keep right	
City: 2 Ref: 645 End panel	
City: 6 Ref: 7001 Road works ahead	
City: 2 Ref: 7010-EP-13-9 Nature of temporary hazard ahead - Road Closed	
City: 3 Ref: 7010-EP-13-9 Nature of temporary hazard ahead - Road Ahead Closed	
City: 1 Ref: 7018 Pedestrian diversion Right	
City: 1 Ref: 7018 Pedestrian diversion Left	
City: 1 Ref: 7105 Lane closure barrier	
City: 2 Ref: TFL 13.9 NLDNOC Narrow lanes do not overtake cyclists	

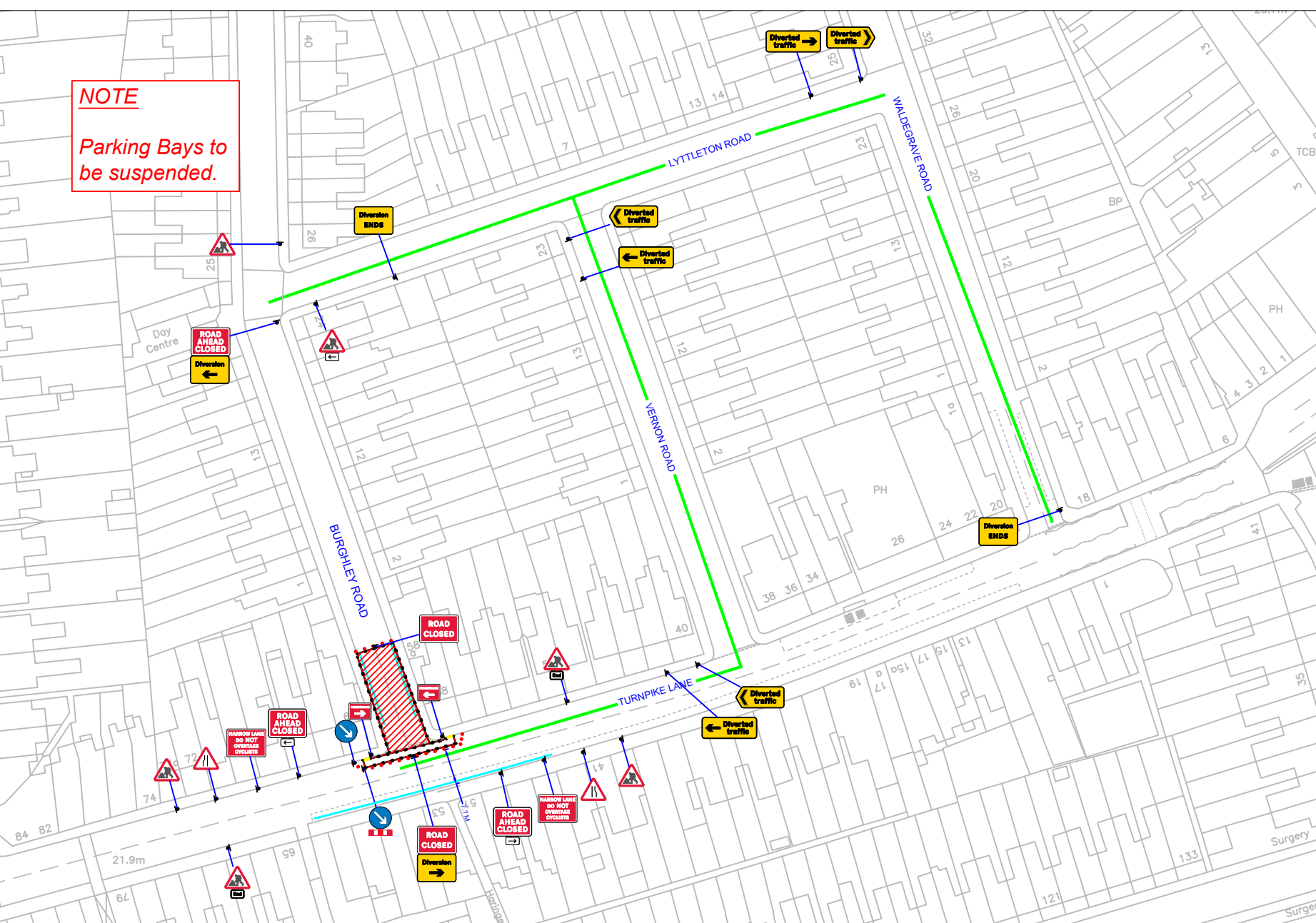

Ordnance Survey © Crown Copyright 2012. All rights reserved. Licence Number 100020449
Speed Limit / Safety Zones
SAFETY ZONE (LOW/DUALWAY) SAFETY ZONE (SIDEWAYS)
0.5M 0.5M

	CONE
	WORKS AREA
	SAFETY ZONE
	TAPER
	SIGNS
	TRAFFIC SIGNAL
	PED SIGNAL
	CLOSURE
	ACCESS ONLY
	DIVERSION
	PARKING SUSPENSION
	PED RAMP
	PED BARRIER

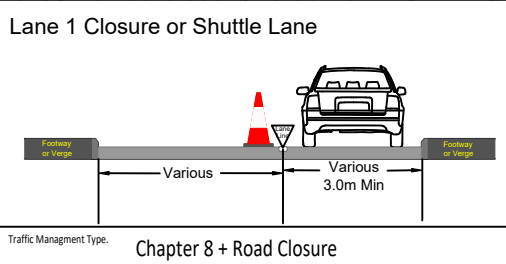

Client: **Haringey LONDON**

Site Address: **Burghley Road London N8 0QD**

Work Details:

Originator: **marlborough**
we understand, we deliver

**Woolf House, 7 Eagle Way
Regiment Business Park
Essex Regiment Way
Chelmsford
CM3 3FY**

Notes:

- All dimensions are in metres unless otherwise stated.
- All traffic management to comply with Chapter 8 and any updates, and Safety at Street Works and Road Work's (A Code of Practice)
- All road markings and signs to be as per the Traffic Signs Regulations and General Directions 2002.
- All permanent traffic signals will be bagged and switched out, at all times that temporary traffic signals are being used. This should be done with approval from said authority.
- A minimum clearance of 1.5m (absolute minimum 1.0m) to be maintained for pedestrians on footways. If this cannot be maintained signs to be placed in the d'wy with associated coning.
- Additional Road Works ahead to be used where appropriate.

Date	25 September 2024	Designer	DS
Scale(s) @ Original Size A3	NOT TO SCALE	Checked	Approved
Drawing Number	MH14436/004	Revision	WC
			P1